

15122023-2.0



RIGGING ROLLER PLATFORM OPERATION MANUAL



(G)

Contents

1. Description and Operation	3
1.2 Main characteristics	3
1.2 Precautions	3
2. Maintenance	5
3. WARRANTY	5

WARNING! Read this manual carefully before using the Product and follow all given instructions.

1. Description and Operation

1.1 Main characteristics

Item No.	Model	Load capacity, t	Dimensions, mm	Rollers	Weight, kg
1005434	CRA-4	6	300x220x130	4 (PU)	11
1005435	CRA-6	8	400x220x130	6 (PU)	15,5
1005442	CRA-8	12	500x220x130	8 (PU)	20
1005443	CRA-9	15	410x320x130	9 (PU)	22
1018891	CRA-12	18	500x320x130	12 (PU)	29

Item No.	Model	Load capacity, t	Dimensions, mm	Rollers	Weight, kg
1005447	CRO-4	6	300x220x130	4 (PU)	10,5
1005451	CRO-6	8	400x220x130	6 (PU)	15
1005452	CRO-8	12	500x220x130	8 (PU)	19
1005453	CRO-9	15	410x320x130	9 (PU)	21
1005445	CRO-12	18	500x320x130	12 (PU)	28

1.2 Precautions

READ THESE INSTRUCTIONS CAREFULLY AND NOTE THE SAFETY INSTRUCTIONS AND WARNINGS. USE THE PRODUCT CORRECTLY AND WITH CARE FOR THE PURPOSE FOR WHICH IT IS INTENDED.

FAILURE TO DO SO MAY CAUSE DAMAGE TO PROPERTY AND/OR SERIOUS PERSONAL INJURY. KEEP THIS INSTRUCTION MANUAL SAFE FOR FUTURE USE.

This product may be used by persons over 18 years of age, with sufficient experience and knowledge, without physical, sensory or mental impairment. Users of the product must have received appropriate training, be familiar with the safety instructions and be aware of the risks involved.

- Children should not play with the Product.
- Cleaning and user maintenance should not be made by children.
- **Keep working area clean**
- Cluttered areas and obstacles in the path can lead to accidents.
- **Storage of unused product**
- When not in use, appliances should be stored in a dry, high or locked-up place, out of reach of children.
- **Do not overload the Product**
- It will do the job better and safer at the capacity for which it was intended.
- **Use the right appliance**
- Do not force small tools or attachments to do the job of a heavy duty tool. Do not use tools for purposes not intended.

Keep guards and safety devices in place and in good working order

Do not use the appliance without guards or safety devices, if such exist.

Do not overreach

Keep proper footing and balance at all times.

Maintain tools and appliances with care

Keep tools clean and in good condition for better and safer performance. Follow instructions for lubrication and changing accessories.

Always stay alert and watch what you are doing

Use common sense when operating the appliance. Do not use the appliance while you are tired, sick or under the influence of alcohol, drugs, medication or other substances that could affect your ability to react.

Check the appliance for damages

If you notice any damages in the appliance, in its guards or other parts, do not use it until it has been repaired in an authorized service center. Check for alignment of moving parts, free running of moving parts, breakage of parts, mounting and any other conditions that may affect the appliance operation.

Damaged parts should be properly repaired or replaced by an authorized service center unless otherwise indicated in this instruction manual.

Use only original spare parts and accessories

The use of any other spare parts or accessories than original parts may cause a risk of personal injury.

REPAIRS SHOULD ONLY BE CARRIED OUT BY AN AUTHORIZED SERVICE CENTER USING ONLY ORIGINAL SPARE PARTS, OTHERWISE THIS MAY RESULT IN CONSIDERABLE DANGER TO THE USER.

Specific safety instructions

- Never exceed the maximum capacity of the appliance.
- Always use suitable equipment (e.g. a toe jack) for loading the appliance.
- While loading, ensure that the weight of the load is equally distributed and none of the trolleys is overloaded.
- Ensure that the load is not unbalanced on the trolleys and cannot decline, tip or fall.
- Never operate the appliance on the floor that is slanted, uneven or on different levels.
- Always ensure that the floor is clean and free from objects (e.g. stones) that could damage the wheels of the appliance or cause an abrupt stop, moving of the load or other dangerous situation.
- Never use the appliance for transporting people.
- Do not use the appliance if it is damaged.
- Do not move or transport loads that are unbalanced.
- Always wear protection shoes while lifting or transporting heavy loads.
- Do not put your hands or feet under the load after loading it on the trolleys.

- While transporting the load, always ensure that there is no one nearby who could be knocked down by the moving load. The extent of the danger zone depends on the load to be transported (e.g. the load height, width etc.).

WARNING! The warnings and instructions given in this instruction manual cannot cover all possible conditions and situations that may occur on the worksite. It must be understood by the operator that common sense and caution are factors, which cannot be built into any product, but must be applied by the operator.

2. Maintenance

1. Inspect the trolley and the wheels regularly and before each use to ensure that they are in good operating condition.

2. Keep the wheels clean and remove all the metal pieces, screws, stones and other debris that have collected around them.

3. Lubricate the wheels to ensure that they move freely and effortlessly. This way, the loads are easier to transport.

3. WARRANTY

The warranty period is 12 months from the date of sale to the end customer.

LIMITATION OF LIABILITY:

- Seller will not be liable for product failures caused by use and normal wear and tear.

- The Seller is not responsible for product malfunctions caused by non-observance of operating rules or use of the Product under unacceptable environmental conditions.

- The warranty will be voided if the Product is not regularly serviced and if it is improperly stored.

- This warranty will not be extended to any Product that has been subject to misuse, neglect or accident or which will have been altered or repaired by elements other than Seller's in such a manner as to adversely affect its performance, stability or reability.

- The warranty does not cover the Product that has suffered any mechanical damage.

- The warranty does not apply to a Product that has been altered in any way.

In order to determine the causes of failure, a technical check is carried out for a period of 10 working days from the date of receipt of the Product for diagnosis.

Claims filing:

- Claims concerning found defects can be issued by the Buyer to the Seller within the guarantee period. The Buyer may request a claim form and instructions for filing a claim from the Seller.

- All risks associated with delivery of the Product to the dealer or service center are borne by the owner of the Product.

- Claims related to incompleteness and appearance of the Product will not be accepted after it has been put into operation.



The information in this paragraph is current at the time of printing of this manual. Up-to-date information on warranty service rules is published on the official website of the group of companies TOR INDUSTRIES **www.tor-industries.com** ("Service" section).

PRODUCT PASSPORT

Product Information:

Model

Serial No.

Sale Date / /

Warranty Period

Seller Information:

Company

Address

Phone

SERVICE MARKS

Place for Stamp	All control operations and tests have been carried out. The product is fully equipped, serviceable and ready for use.
Dated: <input type="text"/>	

Maintenance and repair

Type of Maintenance	<input type="text"/>	<input type="text"/>	<input type="text"/>	<input type="text"/>	<input type="text"/>	<input type="text"/>
----------------------------	----------------------	----------------------	----------------------	----------------------	----------------------	----------------------

Type of Maintenance	<input type="text"/>	<input type="text"/>	<input type="text"/>	<input type="text"/>	<input type="text"/>	<input type="text"/>
----------------------------	----------------------	----------------------	----------------------	----------------------	----------------------	----------------------

Type of Maintenance	<input type="text"/>	<input type="text"/>	<input type="text"/>	<input type="text"/>	<input type="text"/>	<input type="text"/>
----------------------------	----------------------	----------------------	----------------------	----------------------	----------------------	----------------------

Type of Maintenance	<input type="text"/>	<input type="text"/>	<input type="text"/>	<input type="text"/>	<input type="text"/>	<input type="text"/>
----------------------------	----------------------	----------------------	----------------------	----------------------	----------------------	----------------------

Warranty Repair	<input type="text"/>	<input type="text"/>	<input type="text"/>	<input type="text"/>	<input type="text"/>	<input type="text"/>
------------------------	----------------------	----------------------	----------------------	----------------------	----------------------	----------------------

Repair	<input type="text"/>	<input type="text"/>	<input type="text"/>	<input type="text"/>	<input type="text"/>	<input type="text"/>
---------------	----------------------	----------------------	----------------------	----------------------	----------------------	----------------------

Date of Maintenance	<input type="text"/>	<input type="text"/>	<input type="text"/>	<input type="text"/>	<input type="text"/>	<input type="text"/>
---------------------	----------------------	----------------------	----------------------	----------------------	----------------------	----------------------

Contractor	<input type="text"/>	<input type="text"/>	<input type="text"/>	<input type="text"/>	<input type="text"/>	<input type="text"/>
------------	----------------------	----------------------	----------------------	----------------------	----------------------	----------------------

The customer confirms that he has familiarized himself with the rules of use of the product. The customer received the manual in English. The customer has no claims to the serviceability, appearance and completeness of the product.

Customer
Signature _____

**Place for
Stamp**

Explosion Drawing

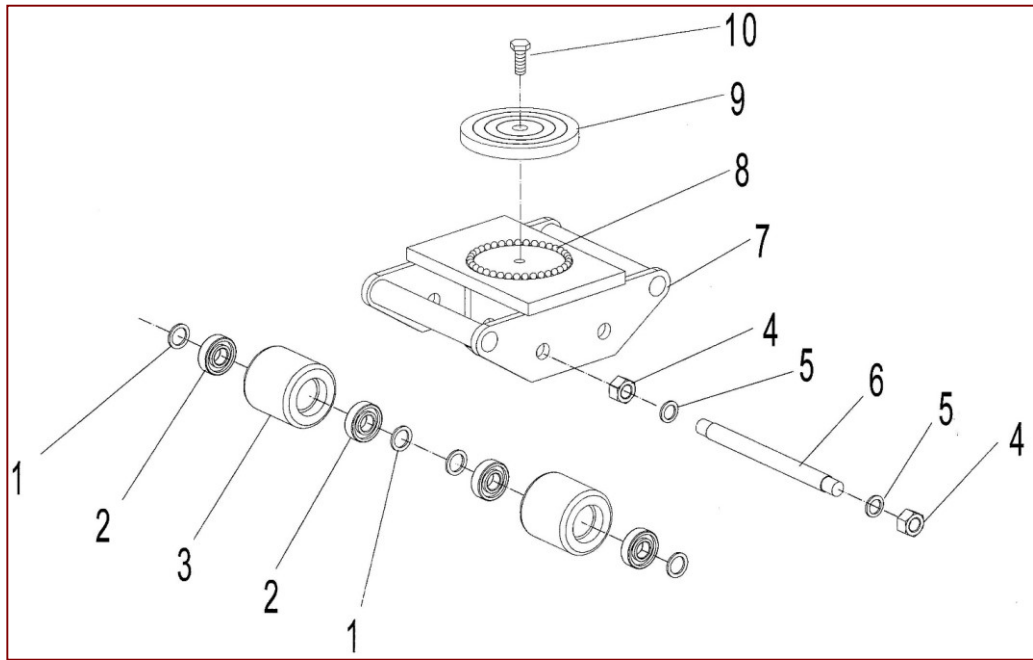

Diagram 1. Rigging platform CRA-4

No.	Name	Q-ty
1	Washer	8
2	Bearing	8
3	Wheel	4
4	Nut	4
5	Elastic Washer	4
6	Axle	2
7	Frame	1
8	Steel Ball	31
9	Turn Plate	1
10	Bolt	1

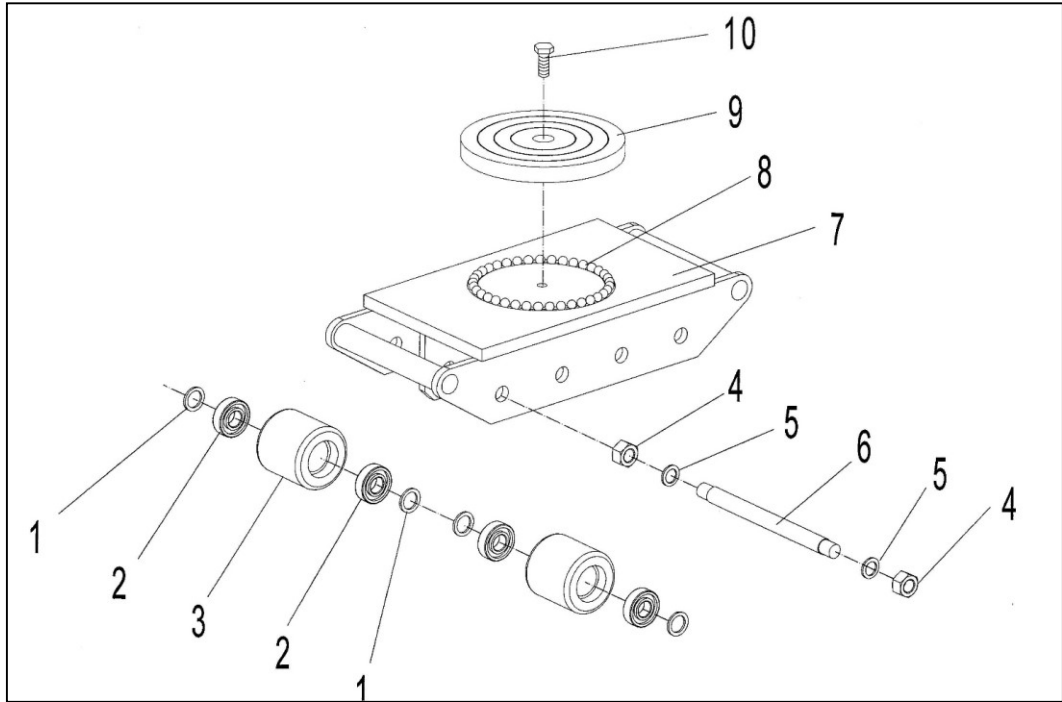

Diagram 2. Rigging platform CRA-8

No.	Name	Q-ty
1	Washer	16
2	Bearing	16
3	Wheel	8
4	Nut	8
5	Elastic Washer	8
6	Axle	4
7	Frame	1
8	Steel Ball	31
9	Turn Plate	1
10	Bolt	1

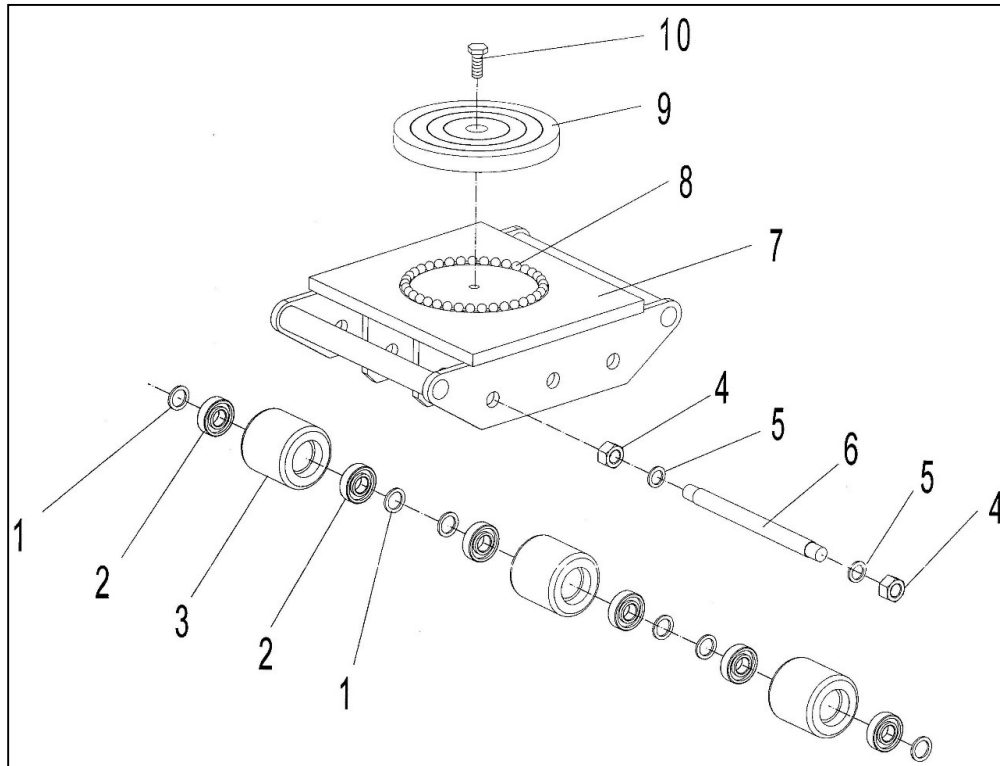

Diagram 3. Rigging platform CRA-9

No	Name	Q-ty
1	Washer	18
2	Bearing	18
3	Wheel	9
4	Nut	6
5	Elastic Washer	6
6	Axle	3
7	Frame	1
8	Steel Ball	31
9	Turn Plate	1
10	Bolt	1

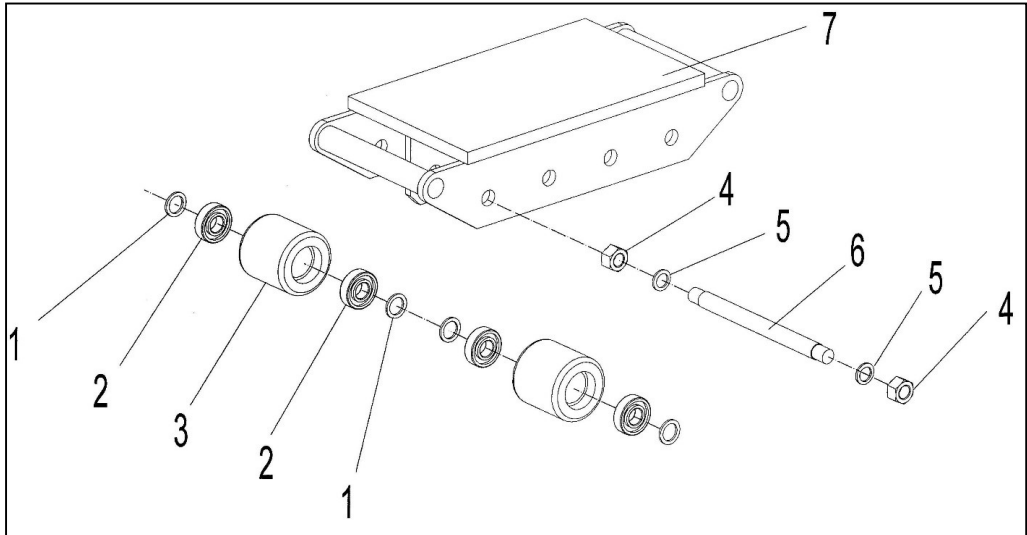

Diagram 4. Rigging platform CRO-8

No	Name	Q-ty
1	Washer	16
2	Bearing	16
3	Wheel	8
4	Nut	8
5	Elastic Washer	8
6	Axle	4
7	Frame	1

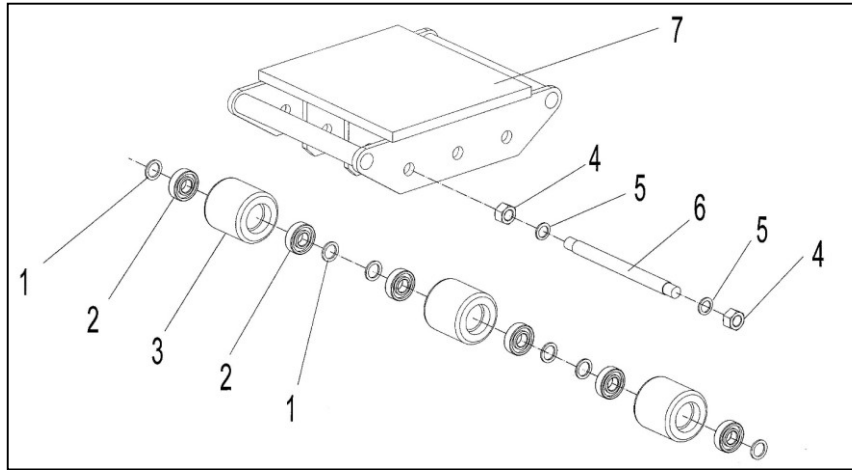

Diagram 5. Rigging platform CRO-9

№	Наименование	Кол-во
1	Шайба (Washer)	18
2	Подшипник (Bearing)	18
3	Колесо (Wheel)	9
4	Гайка (Nut)	6
5	Эластичная шайба (Elastic Washer)	6
6	Ось (Axle)	3
7	Рама (Frame)	1

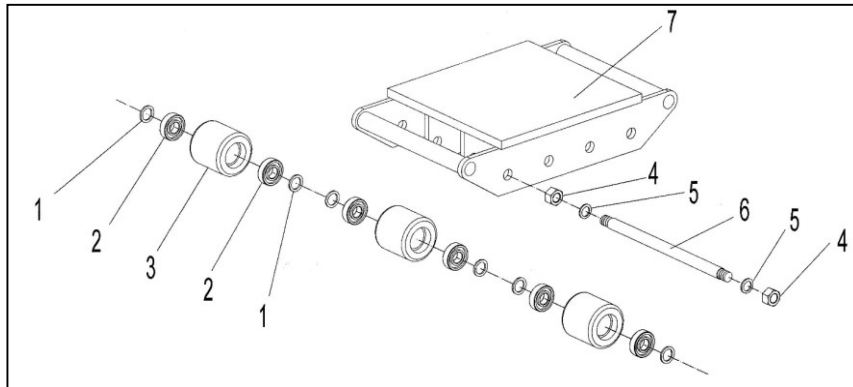

Diagram 6. Rigging platform CRO-12

No	Name	Q-ty
1	Washer	24
2	Bearing	24
3	Wheel	12
4	Nut	8
5	Elastic Washer	8
6	Axle	4
7	Frame	1

